

**ORDINANCE 2009-14**

**AN ORDINANCE OF THE TOWN OF AVON  
TO CHANGE THE ZONING FOR REAL ESTATE  
LOCATED AT THE NE CORNER OF CR 200 N AND CR 900 E**

WHEREAS, the Town Council of the Town of Avon, Indiana has adopted a Zoning Ordinance for the Town that includes a map showing the zone classifications assigned to land within the Town boundaries; and

WHEREAS, a petition ZA 09-04 has been filed by the Town of Avon for 40.00 acres of real estate located at the northeast corner of CR 200 N and CR 900 E, further described in Exhibit A; and

WHEREAS, on May 18, 2009, the Avon Plan Commission conducted a public hearing on the petitioner's proposed zone classification for this territory; and

WHEREAS, in considering this proposal, the Avon Plan Commission has paid reasonable regard to the comprehensive plan, current conditions and the character of current structures and uses in each district, the most desirable use for with the land in each district is adapted, the conservation of property values throughout the jurisdiction, and responsible development and growth, and has certified the proposal with a favorable recommendation to the Avon Town Council for the rezoning of the 40.00 acres of real estate from PUD/Planned Unit Development to R-1, Single-Family Residential; and

WHEREAS, the Avon Town Council has reviewed and considered the Plan Commission's recommendation and has decided to act favorably on this petition.

NOW THEREFORE, BE IT ORDAINED BY THE TOWN COUNCIL OF THE TOWN OF AVON, INDIANA AS FOLLOWS:

Section 1. The 40.00 acres of real estate shown in the attached map (Exhibit B) and described in attached legal description (Exhibit A) be rezoned from PUD/Planned Unit Development to R-1/Single-Family Residential.

Section 2. This ordinance shall be effective immediately upon its adoption.

This ordinance is hereby passed and adopted this 28<sup>th</sup> day of MAY, 2009.

TOWN COUNCIL OF AVON, INDIANA

  
\_\_\_\_\_  
Greg Zusan, President

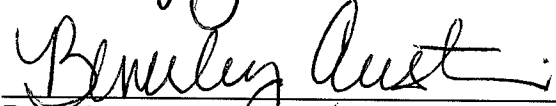
  
\_\_\_\_\_  
Beverley Austin, Vice President

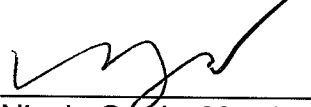
  
\_\_\_\_\_  
Nicole Gordy, Member

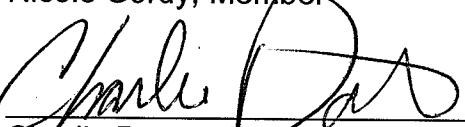
  
\_\_\_\_\_  
Charlie Dorton, Member

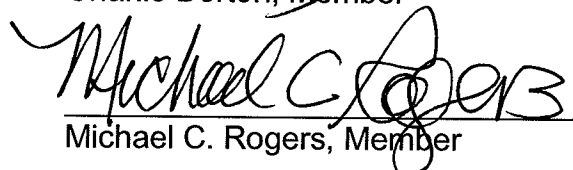
  
\_\_\_\_\_  
Michael C. Rogers, Member

ATTEST:

  
\_\_\_\_\_  
Sharon Howell, Clerk-Treasurer

Exhibit A

**Legal Description: ZA 09-04, NE Corner of CR 200 N and CR 900 E**

40.00 acre parcel in the Town of Avon, Section 30 Township 16N, Range 2E, Parcel Number(s) 12-1-30-62E-300-002, 300-003 & 400-005 located near the intersection of CR 200 N. and CR 900 E.

# ZA 09-04, NE Corner of CR 200 N and CR 900 E

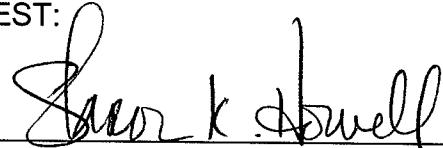
Created By: RCG  
Date Created: 4/13/2009  
Map Scale: 1 in = 723 ft

Location Map

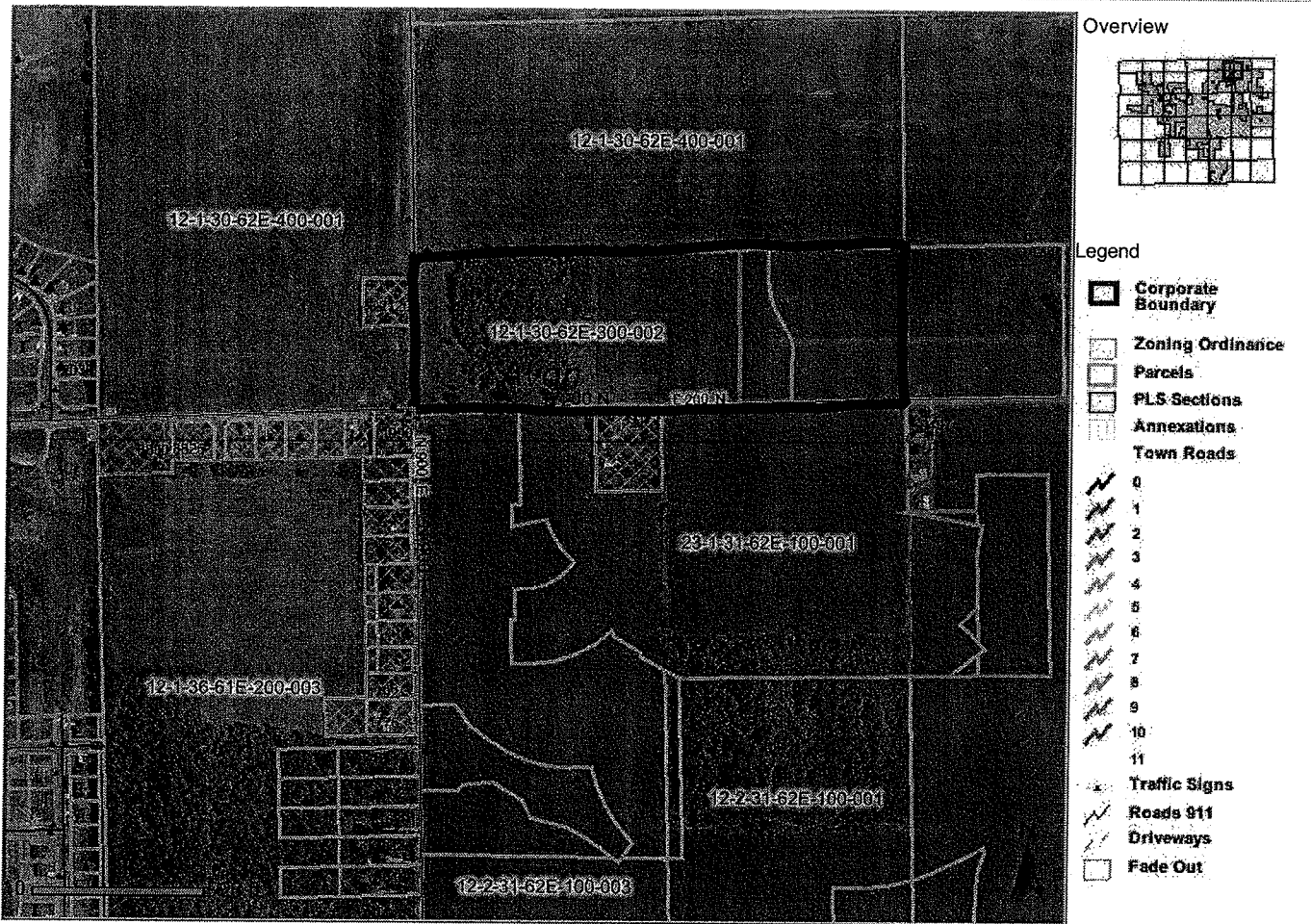

**PARCEL - 12-1-30-62E-300-002**  
#SHAPE# - [Geometry]  
MAPKEY - 55868